

San Gabriel

PHASE II

TIERRA SANTA



3407 Emma Dr, Weslaco, Tx

- \$210,000
- 1746 sq ft
- 3 bedrooms / 2.5 baths

- Prime location in Weslaco, TX the heart of the Rio Grande Valley!
- Adjacent to Tierra Santa Golf Course.
- Close proximity to South Texas College (STC) and Weslaco High School for educational opportunities.
- A mixture of townhome lots and residential homes.

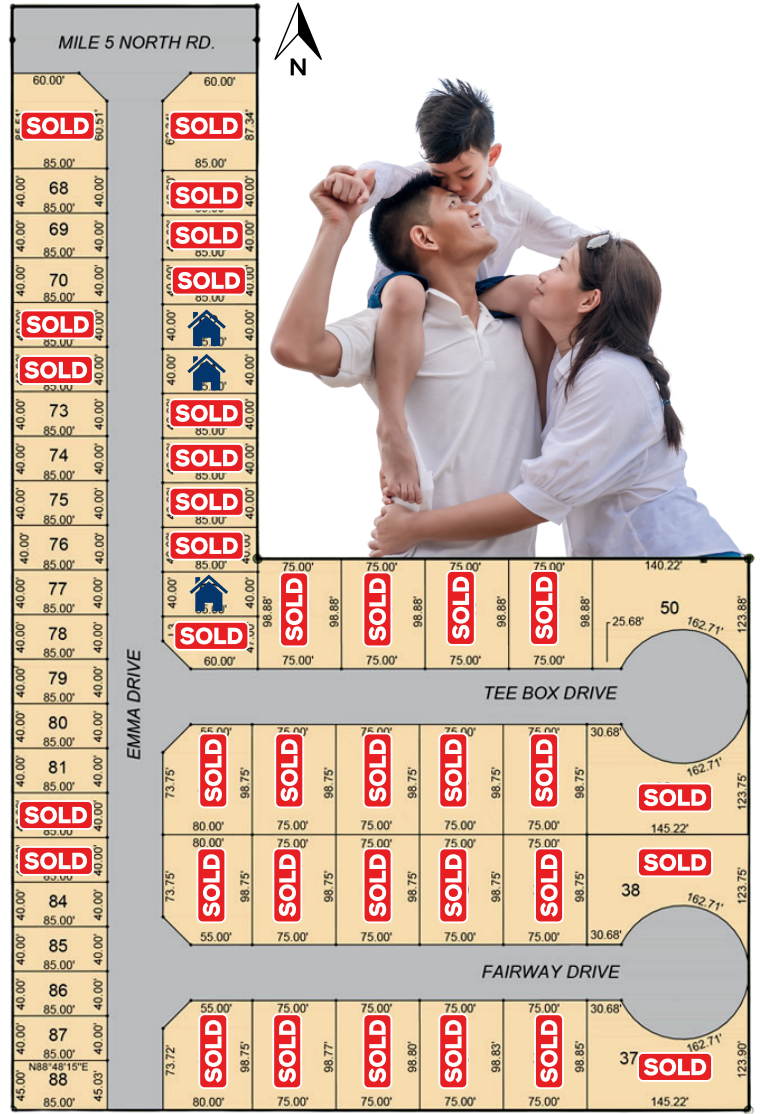

• Townhome For Sale

Lots Starting at \$53,000!



Your dream home awaits at San Gabriel Phase II. Whether you're seeking a spacious lot, custom-built townhome or a stunning residential home, we have the perfect space to suit your lifestyle. Enjoy the best of both worlds with serene surroundings and easy access to amenities like the Tierra Santa Golf Community, top tier schools and local parks. Embrace a life of comfort, convenience, and camaraderie in this thoughtfully planned community.



3409 Emma Dr, Weslaco, Tx

- 2 Story
- \$210,000
- 2117 sq ft
- 3 bedrooms / 2.5 baths

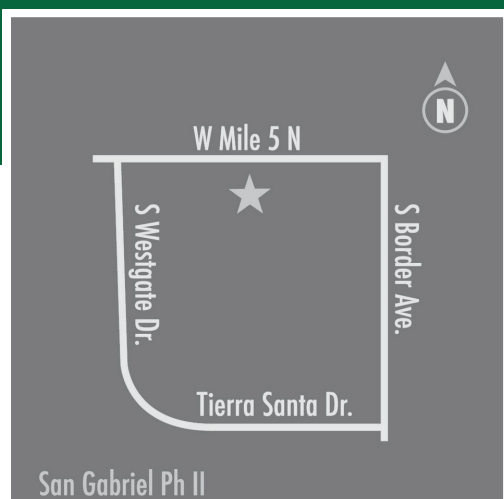

For more information contact our sales team:

Sonia Flores - 956.463.2420

Richie Valdez - 956.793.9760

ReynaDevelopment.com

